



Instructions of New Cash Protector

CAUTION: PLEASE KEEP THE KEYS OUTSIDE OF SAFE PRIOR TO USE THE SAFE

Important Remarks

- For the purpose of security, please change the codes prior to use.
- Please keep codes in a safe place. Do not use personal data like birthdays, telephone numbers...
- Please keep key in a safe place but not in the safe itself!
- If the safe will not be used for a long time, please take out batteries.
- Default personal code is "1234", default master code is "000000"

1. SET NEW PERSONAL CODE

In door open position, press red button (reset switch) at back of the door close to hinge side, display will show "NEU", input new personal 4-6 digit code and press key "LOCK", display will show "AGAIN", input the new personal code again and press "LOCK", display will show "DONE" means new personal code set successfully.

2. SET NEW MASTER CODE

To change master code, lock must be opened (that is, the bolts is retracted). Press key "0" twice then press red button (reset switch) at back of the door close to hinge side, with one short beep and the display shows "OLD", enter old code (pre-selected 0-0-0-0-0). Then press "LOCK" to show "NEW", enter new 6-digit codes. Then press "LOCK", the display will show "AGAIN", re-enter the new code and press "LOCK", the display will show "DONE" indicates new master code changed successfully.

3. TO LOCK THE SAFE

- 3.1 Close the door and turn the knob anticlockwise 90°
- 3.2 Turn the opening key anticlockwise 90° and take out the key, the safe will be locked.

4. TO UNLOCK THE SAFE WITH PERSONAL OR CODE

- 4.1 Insert the opening key and turn clockwise 90°
- 4.2 Input personal code or master code, display will show "OPEN".
- 4.3 Turn the knob clockwise 90° to open the door.

Caution:

Display will show "ERROR" when wrong code inputs. Four wrong code inputs consecutively puts the safe in secure mode. Display will show "HOLD15" in effect the keypad is inactive for 15 minutes, eliminating chances of unauthorized operations.

5. TO UNLOCK WITH EMERGENCY KEY

- 5.1 Use a small philips screwdriver remove the screw in left-down side of panel.
- 5.2 Turn anticlockwise to take off the panel.
- 5.3 Insert the opening key and turn clockwise 90°
- 5.4 Insert the emergency key and turn anticlockwise 45°
- 5.5 Turn the knob clockwise to open the safe.
- 5.6 Fix back with position as picture 5.6 and turn the panel clockwise.

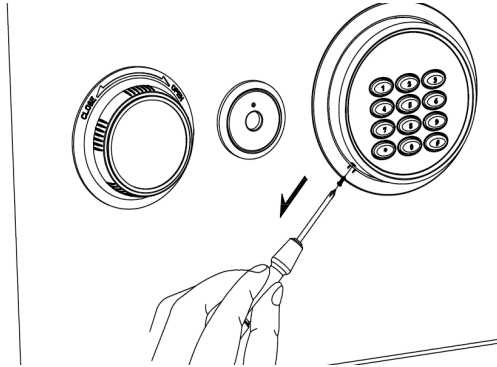

5.1

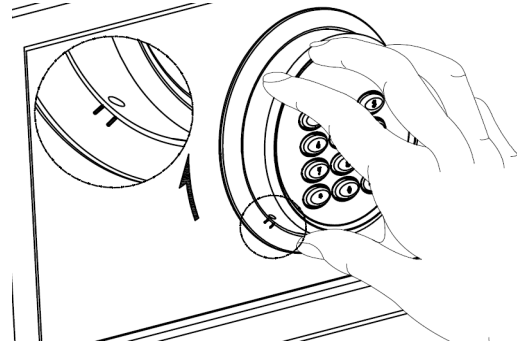

5.6

6. TO REPLACE BATTERIES

If the voltage of batteries is deficient, the display will show “BA-LO” and batteries have to be replaced. Please look at the environmental standards.

7. TO CHANGE TIME DELAY

To change the time delay, lock must be opened (that is, the bolts is retracted). Input “810018” then press red button (reset switch) at back of the door close to hinge side, with one short beep and the display shows current time delay. Input new time delay with two digits (from 00 to 99 minutes) and press “LOCK”.

The display will show “OPEN xx” after input correct code if time delay on.